



© Hegenberg Sellers

# THE CITY OF TOMORROW IS RESILIENT, INTEGRATIVE AND LIVABLE.

## KSP ENGEL

With more than 80 years' experience, five offices in Berlin, Braunschweig, Frankfurt, Hamburg and Munich, and Chinese branches in Beijing and Shenzhen, KSP Engel is both a creative think tank and an efficient network for architecture and urban planning. For more than 30 years, the firm has been active on the international stage and achieved its breakthrough with the Chinese National Library in Beijing. The resonance of this success paved the way for important urban development projects such as the Grand Mosque of Algiers or the Bio-Pharmaceutical Enterprise Accelerator in Shenzhen. Consideration of the economic, ecological, design, and social aspects is one of the fundamental convictions of the firm's owner Jürgen Engel and his management team. After all, anyone wanting to create resilient city structures will have to take all of society's actors into account.



© Marcus Bredt

### Siemens Campus Erlangen, Germany

Our guiding principle for the new Siemens Campus in Erlangen, Germany, is urban integration of architecture, nature, and people. We are reshaping one of the biggest Siemens sites in the world to create an open city district and transforming it into a forward-looking research campus constructed using sustainable timber-hybrid methods. Leafy boulevards lined with shops and restaurants integrate the valuable existing stock of trees and buildings and incorporate the newly created housing developments. Thus, over an area of 54 hectares, an open, lively district is created that combines various uses such as offices, housing, leisure, research and development.





Client: **Siemens AG**  
 Site: **approx. 54 ha**  
 Competition: **01/ 2015, 1<sup>st</sup> prize**  
 Completion: **2020 (Modul 1), 2030 (entire project)**  
 Construction: **largest wood hybrid construction project in Germany**



## Shenzhen Art Museum and Library

The Shenzhen Art Museum and Library is a place of activity, interaction, and communication. The main idea behind the design is to create a public space that links together art, culture, and the urban fabric. In this way, we create a place of understanding between people and culture. The public square – which combines an entrance plaza, a museum, and a library – generates space for dialog, not just between the buildings themselves but also between the visitors, the urban space, and our architecture. The result is a new cultural center and catalyst for urban life in Shenzhen.

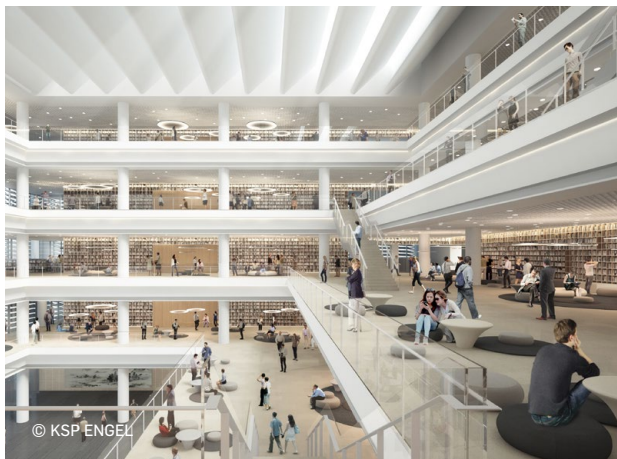

Client: **Shenzhen Art Museum und Shenzhen Library**  
 GFA: **138,000 m<sup>2</sup>**  
 Competition: **11/2015, 1<sup>st</sup> prize**  
 Completion: **2022**  
 Awards: **Shenzhen Architecture Design Prize, 1<sup>st</sup> prize**





© Hegenberg Sellers

# 未来的城市应该具备韧性、综合性和宜居性。

## KSP ENGEL

KSP Engel 拥有 80 多年的经验,在柏林、布伦瑞克、法兰克福、汉堡和慕尼黑设有五个事务所,并在中国北京和深圳设有办事处, KSP Engel 既是一个创意智库,也是一个建筑设计和城市规划的高效专业网络。该事务所在国际上已经活跃了 30 多年,北京的中国国家图书馆项目使得事务所取得了重大突破,为之后赢得重大的城市发展项目铺平了道路,例如阿尔及尔大清真寺、深圳的生物制药企业加速器,等等。对经济、生态、创意和社会方面的全局观是事务所所有者 Jürgen Engel 及其管理团队最基本的信念之一。因为,想要创建韧性城市结构就必须考虑到社会各方面的参与者。



© Marcus Bredt

## 埃尔兰根西门子园区, 德国

我们在德国埃尔兰根新建西门子园区的设计指导原则是:建筑、自然和人与城市的融合。我们正在将世界上最大的西门子办公地点重新设计为一个开放的城区,并将其改造成一个面向未来的研究园区,该园区采用可持续的木质混合结构建造。绿树成荫的林荫大道,伴随着商店和餐厅,结合了珍贵的保留树木和原有建筑物,把新建的住宅区融合联系起来。在这 54 公顷的面积上创造了一个集办公、生活、休闲、研发等多种功能为一体的开放而生动的城市区域。





客户: **西门子股份公司**

用地面积: **约54公顷**

建筑竞赛: **2015年1月, 一等奖**

奠基: **2016年12月 (第一阶段); 2019年10月 (第二阶段)**

完成时间: **2020 (第一阶段) 2030 (全项目)**

建筑: **德国最大的混合木结构建筑项目**



## 深圳美术馆和图书馆, 中国

深圳美术馆和图书馆是一个可以举办各类活动、开展各种互动和交流的场所。我们最初的设计理念就是想要创造一个艺术、文化和城市空间相结合的公共空间。基于这个理念设计了一个人与文化能够相互对话的场所。由入口广场、美术馆和图书馆共同组成的公共广场, 不仅建筑与建筑之间互相呼应, 而且也为客户、城市空间和我们的建筑之间创建了互动空间。这为深圳的城市生活创造了一个新的文化中心, 为城市增添了活力。



客户: **深圳美术馆、深圳图书馆**

建筑面积: **138,000 平方米**

建筑竞赛: **2015年11月, 一等奖**

竣工时间: **2022年**

获奖情况: **深圳市建筑设计奖一等奖**