

# SINO-GERMAN CITY LAB

**Highlights on Urban  
Regeneration Perspectives  
for Chinese Cities**





# Contents

|                                   |           |
|-----------------------------------|-----------|
| <b>Vorwort .....</b>              | <b>02</b> |
| <b>Gerber Architekten .....</b>   | <b>04</b> |
| <b>gmp Architects .....</b>       | <b>06</b> |
| <b>GRAFT .....</b>                | <b>08</b> |
| <b>HPP Architekten .....</b>      | <b>10</b> |
| <b>JASPER ARCHITECTS .....</b>    | <b>12</b> |
| <b>KSP ENGEL .....</b>            | <b>14</b> |
| <b>RhineScheme .....</b>          | <b>16</b> |
| <b>Sauerbruch Hutton .....</b>    | <b>18</b> |
| <b>schneider+schumacher .....</b> | <b>20</b> |

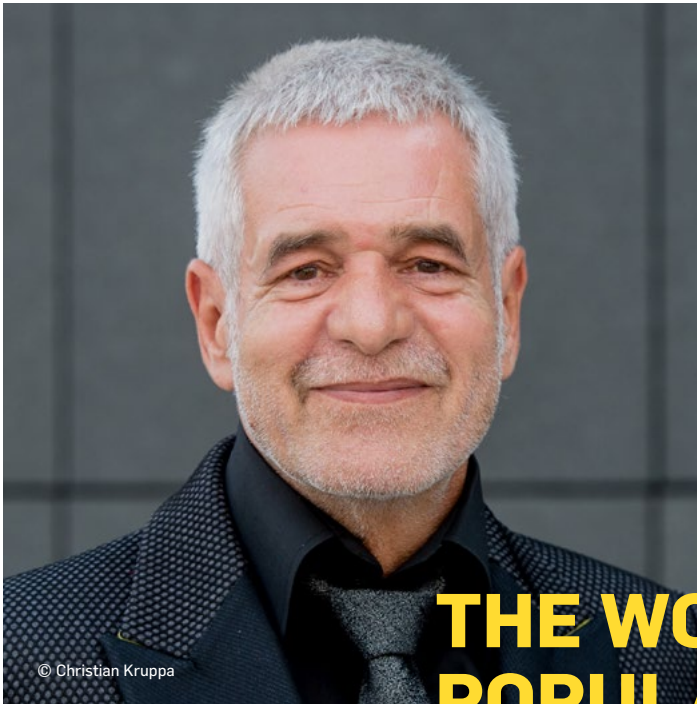

# THE WORLD POPULATION IS GROWING – RESOURCES ON EARTH ARE NOT.

Thus, it is up to us to come up with strategies how to build more resource-efficient, climate-friendly and liveable neighbourhoods in the future. Unused or underdeveloped urban spaces pose a great potential for this challenge – but it takes expertise and careful planning to make the most of it. German architects, engineers and planners have it all: The expertise, the know-how on green technologies/materials as well as sustainable, innovative design and construction.

With the support of the German Federal Ministry for the Environment, Nature Conservation and Nuclear Safety and their Export Initiative for Green Technologies the Network for Architecture Exchange NAX of the Federal Chamber of German Architects has therefore created this year's SINO-GERMAN CITY LAB. With the focus on Urban Regeneration Perspectives on Chinese Cities, and with a wide range of digital activities the lab aims to:

1. Exchange knowledge of environmental and climate protection technologies between German and Chinese actors.
2. Develop urban renewal strategies and perspectives for Chinese cities.

3. Contribute to the improvement of the quality of life and housing in Chinese cities.
4. Contribute to raising awareness regarding a more sustainable use of natural resources and energy consumption.
5. Support the market development in China.
6. Expand the German-Chinese architectural and urban planning network.

The listed architectural practices in this brochure have taken an active part in the SINO-GERMAN CITY LAB. As members of NAX, they are experts in the field of urban regeneration and are successfully realizing projects all over the world. The presented projects stand for a thoughtful, innovative and sustainable approach to architecture and urban planning as well as for the use of green technologies "made in Germany". Do get in touch with them for your project!

## **Prof. Ralf Niebergall**

Vice-President

Federal Chamber of German Architects



# **MODERN, EFFICIENT AND RESOURCE-SAVING TECHNOLOGIES ARE NOT ONLY DRIVERS OF GROWTH AND INNOVATION.**

I am very pleased that the German Ministry for the Environment supports this year's SINO-GERMAN CITY LAB on Urban Regeneration Perspectives for Chinese Cities as part of various projects under the roof of the "Export Initiative for Green Technologies" (EXI), a GreenTech-Funding-Program in which the German Environmental Ministry is working closely together with its partners from the Network for Architecture Exchange NAX.

Modern, efficient and resource-saving technologies are not only drivers of growth and innovation. They also help to raise environmental standards, disseminate environmental knowledge, and thus sustainably improving ecological foundations and living conditions on the ground.

Our experience from the EXI-Program shows that the successful use of green, innovative environmental technologies and services from Germany can contribute to sustainably optimized living and environmental conditions. We aim to overcome infrastructure bottlenecks and help optimizing regulatory frameworks.

In this respect, a laboratory, such as the SINO-GERMAN CITY LAB, is always a place for exchange and experimentation. Together, we want to learn more about the potential of urban regeneration processes and of the opportunities to cooperate.

## **Nilgün Parker**

Head of the Ministries Division for Sustainable Finance, Environmental and Foreign Trade Promotion and the Federal German Ministry for the Environment, Nature Conservation and Nuclear Safety





**WE ARE A REKNOWN,  
AWARD-WINNING  
CONTRIBUTOR TO MAKING  
OUR CITIES MORE LIVABLE.**

## Gerber Architekten

Gerber Architekten have been involved in the built environment for more than 50 years. The international company emphasises a holistic planning approach that addresses both the urban macro- and micro-context as well as the overall landscape situation and incorporates them into the design. In this way, building ensembles are created that set impulses across city districts and thus also lead to the upgrading of the urban context. The synergistic urban renewal projects by Gerber Architekten include university and non-university research and science buildings, trade fair and cultural buildings, office and library buildings as well as infrastructure projects and buildings for the health sector. Many of these projects are visible evidence of the successful structural transformation in the Ruhr region, where an internationally renowned high-tech and service location has emerged from a coal and steel region, with the best conditions for business and science.

### Jinan regeneration projects

Several new urban renewal projects are currently being created from existing building complexes with poor internal structures, lack of daylight, poor management and very little benefit to the local community. With their new forms of use and structural-functional restructuring, they make a valuable contribution to commercial and social life in Jinan. Phase 1 of the Minghu International IT Industrial Park will offer an educational commercial complex while retaining some of the existing buildings. Phase II, on the other hand, comprises new commercial spaces that merge with the urban space. The existing atriums inside the complex are transformed into themed inner courtyard gardens.





## King Fahad National Library

The King Fahad National Library is one of the most important urban development projects in the Saudi Arabian capital.

It not only forms the new centre of the highly fluctuating Olaya District, but has also become an iconographic centre within Riyadh.

The square new building, covered by a filigree, shadowy textile façade, envelops the old library, which has become the central repository of knowledge for the new library as a whole. The square in front has become a popular outdoor meeting place and creates a connection to the urban space, while the library realises a link between the past and the future.

location/country: **Riyadh, Saudi Arabia**

Construction: **2008–2015**

Client: **Kingdom of Saudi Arabia**

GFA: **86,630 m<sup>2</sup>**

Total construction costs: **100.000.000 €**

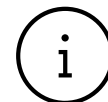
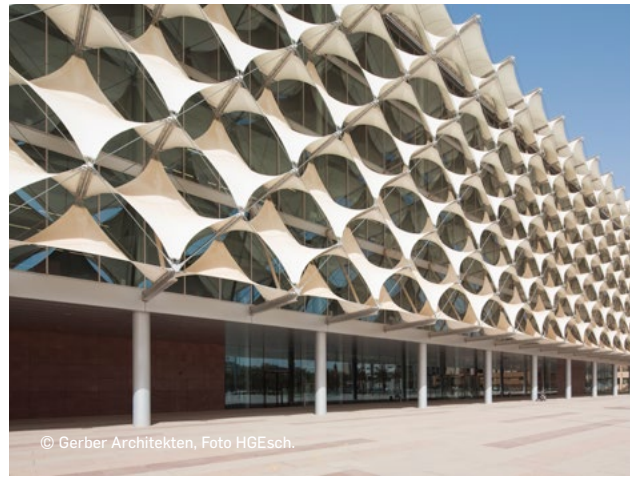

**For more  
information visit  
[www.gerberarchitekten.de](http://www.gerberarchitekten.de)**

location/country: **Jinan, China**

Design: **2018-2019**

Construction: **2020-**

GFA: **166,000 m<sup>2</sup>**



© gmp Architects

Reuse of TXL Berlin Rendering

# FIRST COMES THE CITY, THEN THE INDIVIDUAL BUILDING. VOLKWIN MARG



## gmp Architects

Ecology, economy and society were three important pillars of our architectural approach, even before the current global trend of sustainability came up. It is not only a challenge and moral obligation for us to pay attention to environmental concerns in our projects, but also a tradition.

We understand sustainable urban renewal not only as a mere technical adaptation, but as a further development of existing building typologies and urban structures. The cooperation with other specialists such as landscape architects and urban planners results in objects of stable value with high economic efficiency and efficient use of space: South Bund Waterfront and Zhangjiang Science City in Shanghai, HafenCity in Hamburg, the conversion of the Baowu Stainless Steel factory into the Shanghai Academy of Fine Arts and recently the reuse of Berlin-Tegel Airport (TXL).

### South Bund Waterfront, Huangpu District, Shanghai

In 2011, gmp won the urban design competition for the South Bund area located between Huangpu River and Shanghai's Oldtown and was subsequently commissioned with the design of the 2.2 km long public promenade along the river. Completed in 2019, the „wave promenade“ recalls the historical urban structure of the streets and alleys leading from the Oldtown to the historic harbor: At each point where a street meets the riverbank, the promenade is led outward in a slight wave, analogous to the boat docks formerly located at these points.

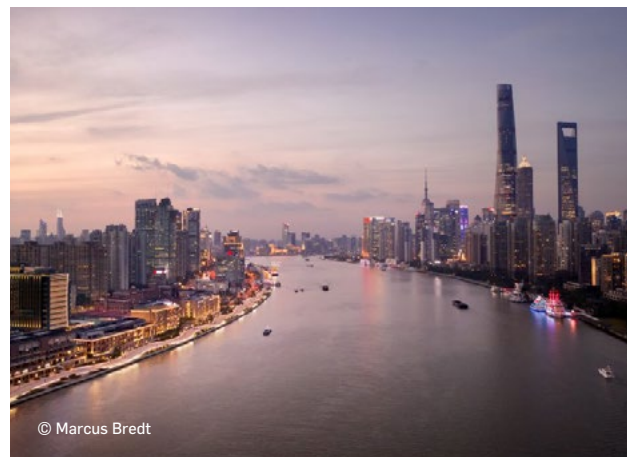

© Marcus Bredt

South Bund Waterfront Night View



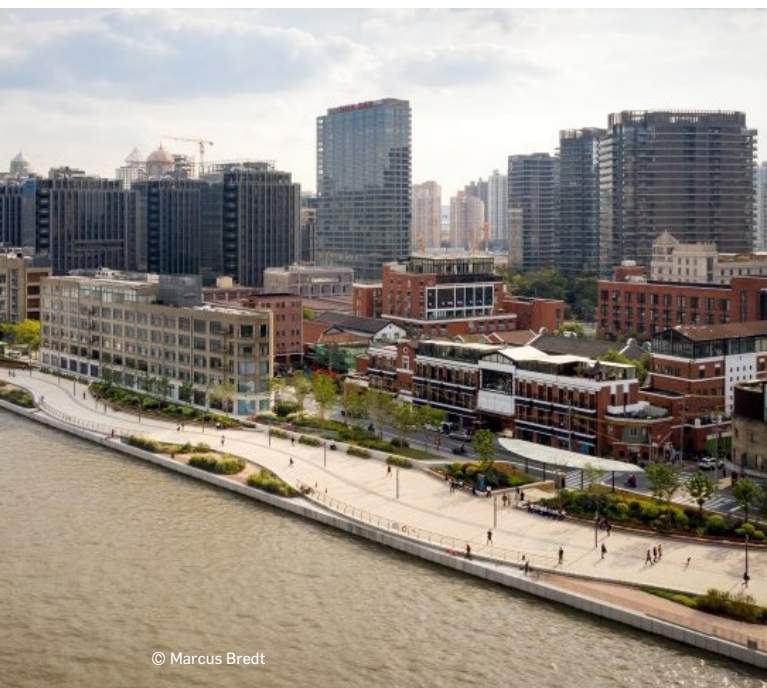

© Marcus Bredt

South Bund Waterfront

Design: **Meinhard von Gerkan and Nikolaus Goetze with Magdalene Weiss**

Project Lead: **Magdalene Weiss, Fanny Hoffmann-Loss**

Project Management China: **Cai Lei**

Landscape Architecture: **WES LandscapeArchitecture**

Client: **Shanghai Bund & Riverside Comprehensive Development Co., Ltd.**

Planning Area: **700,000 m²**



For more information visit

[www.gmp.de/en](http://www.gmp.de/en)



© Willmore CG

Bird's-eye View Southeast at Night

### Disused stainless steel factory

### turned into Shanghai Academy of Fine Arts

The conversion of Baowu Stainless Steel factory is an outstanding example of urban renewal and upgrading of former heavy industry areas in Shanghai. The 860-meter-long building will be renovated and expanded to accommodate the Shanghai Academy of Fine Arts. The distinctive steel and concrete structure will be retained, including the characteristic ventilation towers on the roof to increase natural light and enhance ventilation. The interaction of old and new construction can be experienced in a shared, central core space for the art academy that connects through the entire length of the building.



© Willmore CG

Central Corridor

Design: **Meinhard von Gerkan and Nikolaus Goetze with Magdalene Weiss**

Competition Lead: **Li Yang**

Project Management China: **Pan Mei, Zhang Yayun**

Structural Engineering: **schlaich bergemann partner**

Energy Consultant: **Transsolar Energietechnik GmbH**

HVAC consultant: **Institute of HVAC Engineering, Tongji University**

Client: **Shanghai Baosteel Stainless Steel Co., Ltd.**

GFA: **220,000 m²**



© Pablo Castagnola, Berlin

From left to right: GRAFT Founding Partners  
Thomas Willemeit, Wolfram Putz,  
Lars Krückeberg

## URBANITY IS BECOMING A NEW WAY OF LIVING AND THINKING, DUE TO NEW FORMS OF NETWORKING AND MOBILITY.

### GRAFT

GRAFT was founded in 1998 in Los Angeles, California by Lars Krückeberg, Wolfram Putz, and Thomas Willemeit and operates internationally in the fields of urban development, architecture, and design. The hybrid office with further locations in Berlin and Shanghai is characterized by its innovative and interdisciplinary design methods and futuristic design language. With offices on three different continents spanning numerous time zones, for GRAFT, coexisting identities are not a reality to struggle with, but the ideal premise for fostering ideas that break new ground. Architecture — especially on the scale of urban planning — is a powerful tool for representing multiple, partly overlapping identities with the necessary complexity. GRAFT's designs are cultural expressions that derive from a multitude of identities.



BRICKS © BTTR GmbH

### BRICKS

GRAFT revitalized the historical post office premises in Berlin Schöneberg, expanding it with two new buildings and converting the original rooftops for commercial purposes. Thus a 32,000m<sup>2</sup> modern ensemble accessible to the public was created comprising offices, restaurants, retail outlets and apartments. The area around the building complex is one of the busiest residential districts in the city with restaurants and shops as magnets as well as green spaces within walking distance. The different buildings are distinguished by their own individual character resulting from their development throughout the decades. In accordance with the existing building structure, the previously unused rooftops were renovated by GRAFT according to the historical model and in compliance with the regulations for the protection of historical monuments.



Location:

**Hauptstrasse 27,28-29, 10827 Berlin / Belziger Strasse 33, 10823 Berlin, Germany**

Project type:

**Revitalization of a former post office area, conversion for commercial university and gastronomy, extension by two new residential buildings**

Client:

**Trockland Management GmbH**

Year:

**2014– 2020**

Size:

**32,000 m<sup>2</sup> (15,200 m<sup>2</sup> revitalization and roof extension, 16,800 m<sup>2</sup> new construction)**

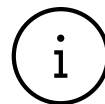
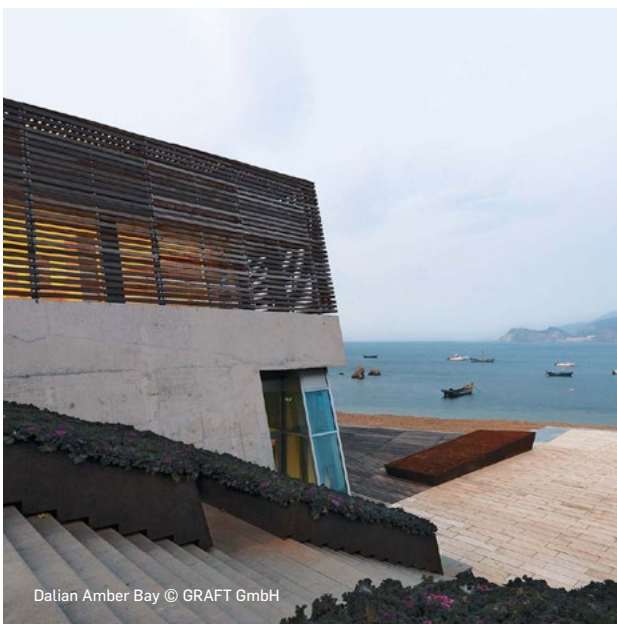

**For more information visit  
[www.graftlab.com/en](http://www.graftlab.com/en)**

### **Dalian Amber Bay**

Amber Bay lies on Binhai Road, Dalian's famous scenic coastal road on the Chinese city's southeast side. GRAFT's main design intent was to develop an architectural language which complements the natural setting of the sensitive beachfront area. The design imagined a topographical landscape, that could be perceived as a natural configuration of publicly accessible platforms, stairs and roof terraces. A boardwalk serves as a public promenade along the half-moon of the beach, its wooden decking providing a natural transition between building and bay, softening the arced edge of the development as it blends into the sand.

Location: **Dalian, China**

Client: **Dalian Amber Bay Development Co. Ltd.**

Project type: **Urban planning, restaurants, retail**

Year: **2007**

Size: **16,000 m<sup>2</sup>**





© HPP Architects

The renewal of Xujiahui Sports Park retains and transforms the four main existing sport buildings and designs new green spaces and water areas that allow a variety of recreational and sporting opportunities for the densely built-up residential areas of Shanghai.

## PROFESSIONAL EXPERTISE AND LOCAL CULTURAL KNOWLEDGE ARE CRUCIAL FOR THE SUCCESS OF URBAN RENEWAL.

### HPP Architekten

HPP Architects is one of Europe's leading architectural partnerships with a full range of architectural and master planning services. Since its foundation, the 4<sup>th</sup> generation of HPP partnership today includes a global team of more than 25 nationalities and 450 architects, engineers, urban designers and specialists. Today it comprises 13 offices including 8 regional offices in Germany and 5 international branches in Turkey, China and Netherlands.

HPP aspires to create architectural quality of lasting value beyond the here and now: timeless and yet clearly part of their time, innovative and equally grounded in history.

HPP has been involved in urban regeneration projects in China for many years. Among others, we are currently working on the renewal of the Xujiahui Sports Park in Shanghai, the Huairou Cement Factory renovation project in Beijing and the Nanshan Science & Technology Innovation Center in Shenzhen.

#### **Huairou Cement Factory, Beijing**

On the site of the former Cement Factory in northern Beijing across an area of over 60 hectares a new component of the Huairou Science City is to be created: a lively campus for the Xingfa Beijing Institute for Mathematical Sciences. The new district will be defined by numerous supplementary new buildings and high-quality free spaces. Besides laboratories and research facilities there will be residential space for teachers, researchers and students of the institute as well as shops, cafés and a sports centre.



© HPP Architects



Client: **Beijing Xingfa Cement Co., Ltd**  
 Location: **Beijing**  
 Site: **61.35 ha**  
 GFA: **182,200 m<sup>2</sup>**  
 Completion: **2022 /**  
**Competition 1<sup>st</sup> Prize**

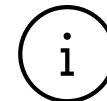

For more  
 information visit  
[www.hpp.com/en](http://www.hpp.com/en)

The Huairou Cement Factory renovation project in Beijing transforms a former factory site into a lively campus.

## Nanshan Science & Technology Innovation Center

The Nanshan STIC provides an ecosystem for businesses from start-up to expansion. High-quality, urban recreation spaces for public use as well as office, residential and research buildings will be created on a total area of 120,000 m<sup>2</sup>. Designed as a new centre, it offers a networked and forward-looking environment for business growth - from the initial start-up to the subsequent corporate enterprise. Elevated, green terraces at heights of ten to fifty metres connect the city with seven newly-conceived skyscrapers. Within this 'incubation platform', new companies will have opportunity to develop and grow, but also to benefit from their direct neighbours.



Nanshan Science & Technology Innovation Center: An entire city as a start-up incubator.



Architects: **HPP, SZAD, AEP**  
 Client: **Government of Nanshan District, Shenzhen**  
 Location: **Shenzhen, China**  
 GFA: **1,050,000 m<sup>2</sup>**  
 Competition: **1<sup>st</sup> prize 2018**





© Marianna Garin

# 70% OF HUMANITY WILL LIVE IN CITIES BY 2050 - A CENTRAL CHALLENGE FOR URBAN RENEWAL.

## JASPER ARCHITECTS

JASPER ARCHITECTS was founded by Martin Jasper in 2008 with branches in Berlin, Buenos Aires and Vienna. The cross-cultural working defines the character of the office. The projects span from interior design and building design to urban planning, and follow a common methodology: they adapt to the local milieu, history and context through a profound analysis of the local parameters. JA's projects face different levels of urban renewal, both in scale and typology, in metropolitan contexts in different continents. All follow a careful and meticulous handling of the existing urban substance, equally for restorations and building extensions. The values of the existing are identified and well-kept when adaptations to new functional parameters take place, translating historical concepts into the present. Additions are conceptualized to respect and highlight the qualities of the existing.

### UP! Berlin

A new chapter for an icon of Berlin's city history: JASPER ARCHITECTS transformed an aging iconic department store into a modern place for work and retail in Berlin. The 67,000m<sup>2</sup> project named "UP!" reveals the building's past and points to its future with a new appearance and a new, entirely glazed building envelope. In order to create bright spaces for the new functions, the formerly closed cube was gutted and then flooded with natural light via canyon-like terraced cut-outs on all four sides. Two additional floors and a roof terrace bring plenty of light and air into the future offices.

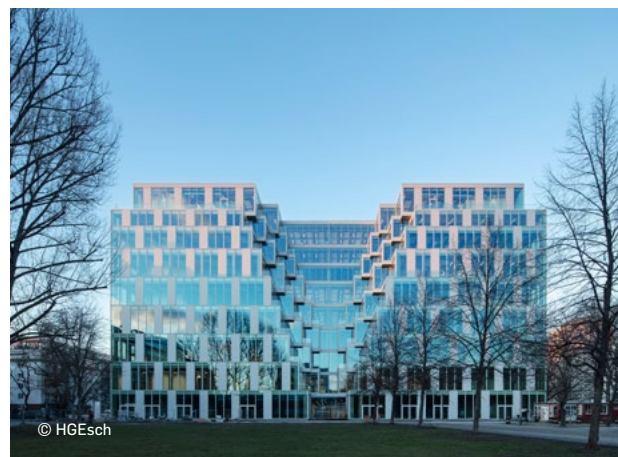

© HGEsch

Front Facade after Renovation





Courtyard View

## Długa Housing, Warsaw

In the heart of Warsaw, a historic building complex is being renovated and two buildings are being added. Composed of a historical and a listed tower and a pavilion from the 1950s, an apartment and student housing complex with a public courtyard is being created. The concept envisages an extension of the green areas of the adjacent Kraszinski Park into the courtyard in order to bring the green abundance of the park to the buildings. This concept is integrated vertically into the façades of the new buildings, which through their cantilevering volumes create extensive terraces for the units. An all in all sustainable approach towards urban renewal of a historical site.



View from Kraszinski Park

Location: **Warsaw, Poland**  
 Destination: **Office and Retail**  
 Year: **2018-2023**  
 Size: **ca. 20.000 m<sup>2</sup> GFA**  
 Client: **ZEITGEIST**  
 Project costs: **> 30 Mio EUR**

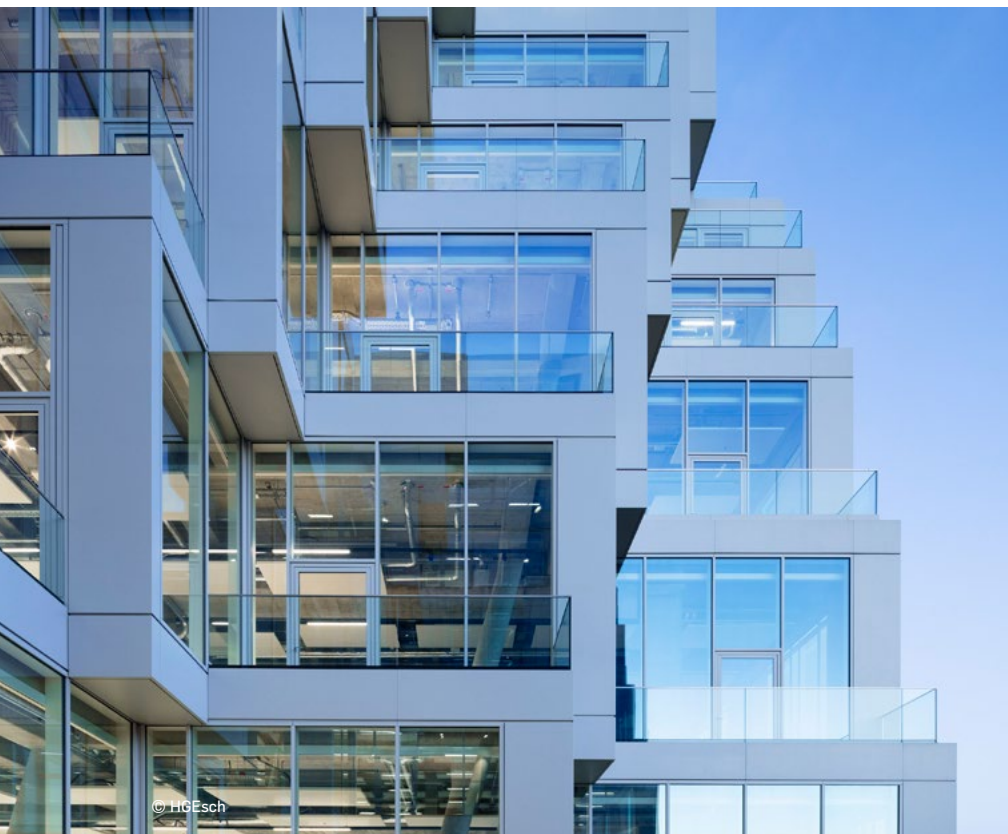

Detail of the Canyon Terraces

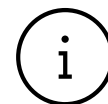

**For more  
 information visit  
[www.jasperarchitects.com](http://www.jasperarchitects.com)**

Location: **Berlin, Germany**  
 Destination: **Office and Retail**  
 Year: **2021**  
 Size: **ca. 65.000 m<sup>2</sup> GFA**  
 Client: **SIGNA**  
 Project costs: **> 100 Mio EUR**



© Hegenberg Sellers

# THE CITY OF TOMORROW IS RESILIENT, INTEGRATIVE AND LIVABLE.

## KSP ENGEL

With more than 80 years' experience, five offices in Berlin, Braunschweig, Frankfurt, Hamburg and Munich, and Chinese branches in Beijing and Shenzhen, KSP Engel is both a creative think tank and an efficient network for architecture and urban planning. For more than 30 years, the firm has been active on the international stage and achieved its breakthrough with the Chinese National Library in Beijing. The resonance of this success paved the way for important urban development projects such as the Grand Mosque of Algiers or the Bio-Pharmaceutical Enterprise Accelerator in Shenzhen. Consideration of the economic, ecological, design, and social aspects is one of the fundamental convictions of the firm's owner Jürgen Engel and his management team. After all, anyone wanting to create resilient city structures will have to take all of society's actors into account.



© Marcus Bredt

### Siemens Campus Erlangen, Germany

Our guiding principle for the new Siemens Campus in Erlangen, Germany, is urban integration of architecture, nature, and people. We are reshaping one of the biggest Siemens sites in the world to create an open city district and transforming it into a forward-looking research campus constructed using sustainable timber-hybrid methods. Leafy boulevards lined with shops and restaurants integrate the valuable existing stock of trees and buildings and incorporate the newly created housing developments. Thus, over an area of 54 hectares, an open, lively district is created that combines various uses such as offices, housing, leisure, research and development.





Client: **Siemens AG**  
 Site: **approx. 54 ha**  
 Competition: **01/ 2015, 1<sup>st</sup> prize**  
 Completion: **2020 (Modul 1), 2030 (entire project)**  
 Construction: **largest wood hybrid construction project in Germany**



## Shenzhen Art Museum and Library

The Shenzhen Art Museum and Library is a place of activity, interaction, and communication. The main idea behind the design is to create a public space that links together art, culture, and the urban fabric. In this way, we create a place of understanding between people and culture. The public square – which combines an entrance plaza, a museum, and a library – generates space for dialog, not just between the buildings themselves but also between the visitors, the urban space, and our architecture. The result is a new cultural center and catalyst for urban life in Shenzhen.

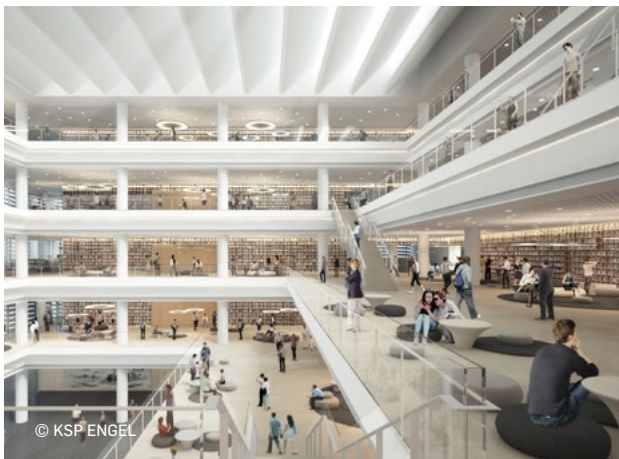

Client: **Shenzhen Art Museum und Shenzhen Library**  
 GFA: **138,000m<sup>2</sup>**  
 Competition: **11/2015, 1<sup>st</sup> prize**  
 Completion: **2022**  
 Awards: **Shenzhen Architecture Design Prize, 1<sup>st</sup> prize**



For more information visit  
[www.ksp-engel.com/en](http://www.ksp-engel.com/en)





# PLANNING FOR AND LIVING IN THE CITY NEEDS TRUST AND BELIEF IN THE CIVIL SOCIETY, NO MATTER WHERE.

## RhineScheme

RhineScheme is a worldwide acting design group with 40+ years of professional experience in planning and construction management. 200 planners are working in branch offices in Germany (Cologne, Hamburg, Leipzig) and China (Beijing, Shanghai). RS works in integrated planning teams made up of architects, urban, landscape, and interior designers, as well as plenty of associated engineers and consultants.

Urban renewal is at the core of our interests: Transformation is telling a story, it transfers a complex identity to a place. The attraction of demolish & rebuild however, targeting at uncompromising topicality, often evaporates after a short time. In China since 2004, RS has created a unique project portfolio. 30 professionals - half local, half foreign – form an experienced working team, familiar with Chinese & Western planning culture, and combining international experiences with local know-how.

### Changchun Garden Mall

Expected to be finished by 2023, this advanced type of experience mall combines shopping-leisure-culture-sports-events-entertainment-F&B in a setting that inspires the senses.

The multiple times awarded Mall is located a stone's throw from the new High-Speed Railway Station. Adjacent to a transportation hub with annually 60 million passengers, the Mall will be business cluster and center of life for LOHAS-style consumers, the sheer opposite of 'one-time sales commerce'.

The building will kick off a commercial benchmark for the fourth consumer era, abandon premium brand consumption habits and boost the shopping and life-style experience of a new generation of consumers.



Northwest view / main access



## Renewal of Fuzhou Wenchangli District

The subtropical city of Fuzhou is avant-garde in urban renewal, with the first city-level administration in China dedicated to protecting cultural heritage.

Its Wenchangli District contains outstanding historical landmarks, e.g. the house of playwright Tang Xianzu, the third largest Catholic Church in China, or outstanding Minguo style buildings. It is the most complete cultural area in the city.

RhineScheme's awarded intervention planning protects built & unbuilt heritage, takes care of its gradual improvement, and preserves the cultural values while organically incorporating business and commercial functions related to tourism.



Renewed Wengjie Street

Location: **Fuzhou, Jiangxi Province / China**

Design period: **2016.4 – 2018.3**

Client: **China Academy of Urban Planning & Design (CAUPD)**

Scope of services: **Architectural Design, Renovation Planning, Landscape Design**

Planning area: **2.9 ha**

GFA: **25,500 m<sup>2</sup>**



Aerial view of main intervention area



Aerial view from nearby HSR Station

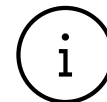

For more  
information visit  
[www.rhinescheme.com](http://www.rhinescheme.com)

Location: **Changchun, Jilin Province / China**

Design period: **2018.9 – 2020.3**

Client: **Qingyifang Group Changchun**

Planning area: **18 ha (urban design scope)**

Scope of services: **Masterplan, Architectural and Landscape Design**

GFA: **184,000 m<sup>2</sup>**



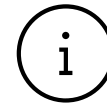

**For more  
information visit  
[sauerbruchhutton.de/en](https://sauerbruchhutton.de/en)**

# ARCHITECTURE AS A BEACON OF URBAN RENEWAL

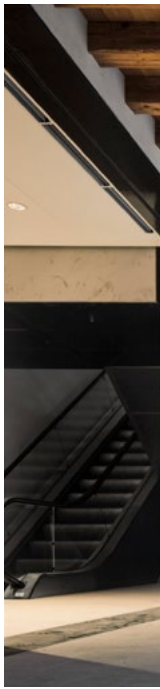

## Sauerbruch Hutton

Sauerbruch Hutton's approach to urban renewal builds upon the existing, but also defines the city anew by understanding it as a living organism that is constantly evolving. Combining the familiar with the unexpected, Sauerbruch Hutton's projects craft new sensual city fabrics and city scapes that encourage individual awareness and positively engage with the environment. Our architectural interventions are conceived to be as sustainable as possible, engaging with the urban context to achieve significant reductions in CO<sub>2</sub> emissions and other environmental improvements. Technical innovation is sought through intelligent and innovative architecture. Sauerbruch Hutton believes that individual buildings can make a difference, with the context of the place and its climate acting as source of inspiration in the quest for the city's sustainable future.



### M9 Museum, Venice-Mestre

The M9 Museum is host to a rich Italian 20<sup>th</sup> Century cultural inheritance. The project is conceived as a decisive urban intervention in the city of Venice-Mestre intending to act as a catalyst to bring back new life to its existing fabric by creating a new public pedestrian link and piazza. The site used to be a military compound that for decades was a void at the city centre, resulting in detours for pedestrians due to the lack of access. Significantly, the site includes a listed 16<sup>th</sup>-century Church, two listed former stables and an office building from the seventies and eighties.



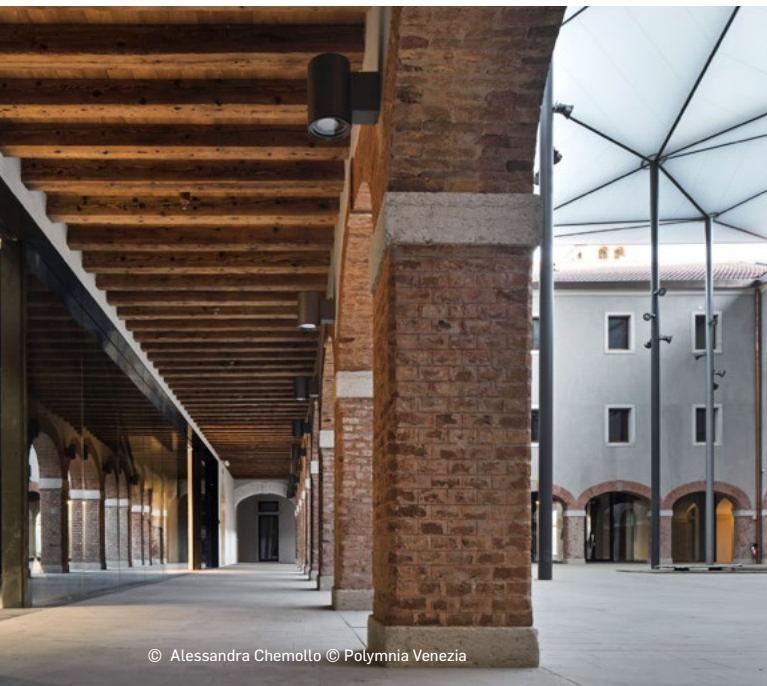

Project type: **Museum with media centre and auditorium, offices, conferences centre, retail and restaurants**

Client: **Fondazione di Venezia; Polymnia Venezia**

Location: **Venice Mestre, Italy**

Project area: **25,600 sq m**

Project dates: **2010 competition 1<sup>st</sup> prize; 2014 - 2018 construction**

Key awards & certifications:

- **Mies van der Rohe Award 2019, shortlist**
- **Polis Award 2017, nomination**
- **International Urban Project Award 2019, shortlist**
- **Premio Pietro Torta 2019**
- **Otto Borst Prize for Urban Renewal, 2020**
- **The Plan Award 2020**



## Ministry for Urban Development and the Environment, Hamburg

Hamburg's State Ministry for Urban Development and the Environment (BSU) was the flagship project of the International Building Exhibition, 2013. This urban renewal was crucial to the development of the marginalized industrial area of Wilhelmsburg, due to its proximity to the renowned port of Hamburg. The disappearance of various industries meant the area fell into disrepair and depopulation. Now the area has been transformed. The BSU building and its coloured façade act as a reference point for all visitors and citizens as well as setting an example for sustainable real-estate in the area.



Project type: **Offices with exhibition space, conference area, restaurant**

Client: **Sprinkenhof AG**

Location: **Hamburg, Germany**

Project area: **61,400 sq m**

Project dates: **2009 competition 1<sup>st</sup> prize; 2009 - 2013 construction**

Key awards & certifications:

- **German Association of Architects Hamburg Architecture Prize 2014**
- **IBA-Excellence, Award of the International Building Exhibition, Hamburg 2013**
- **DGNB Certificate 'Gold'**



© Rainer Taepper

The office's spectrum ranges from housing to industrial buildings, from a highway church to high-rises, and from museum work to a particle accelerator.

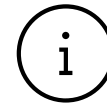

For more information visit  
[www.schneider-schumacher.com](http://www.schneider-schumacher.com)

## WE FOCUS ON ADAPTING EXISTING BUILDINGS TO CHANGING NEEDS.

### **schneider+schumacher**

Simplicity and perfection, discipline and creativity, economy and memorable images. For schneider+schumacher – with branches in Germany, Austria and China – these are not contradictory notions, but essential components for generating good architecture in its broadest sense. The office's spectrum ranges from housing to industrial buildings, from a highway church to high-rises, and from museum work to a particle accelerator.

Worldwide, more people live in cities than in the countryside. This requires a holistic approach that promotes discussion about cities and their architecture. Focusing on urban renewal, the question of how to treat existing building fabric is gaining significance – both in terms of cultural heritage and with regard to sustainability. schneider+schumacher focuses on adapting existing buildings to changing needs, while ensuring future-proof sustainable improvement.

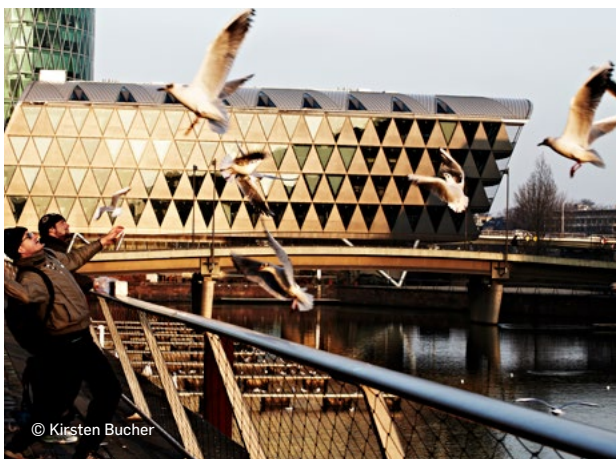

© Kirsten Bucher

In accordance with its name the Bridge Building bridges the different height levels between Westhafenplatz and the river Main embankment.

#### **Urban quarter Westhafen**

The Westhafen quarter is one of the most interesting and attractive urban developments in Frankfurt due to its central location and being right on the river. schneider+schumacher developed main parts of the master planning and executed four of its key buildings: The Westhafen Tower constitutes the landmark of the urban quarter, the Bridge Building marks the ending of the riverside park, the Westhafen House connects the quarter to the buildings on Speicherstrasse and the overall appearance of Westhafen Pier fits naturally in front of the power station silhouette.





© Kirsten Bucher

In this triad of buildings on the Westhafen, the Westhafen Tower marks one of the main entry points into the city.

location/country: **Frankfurt, Germany**  
year: **2000-2004**

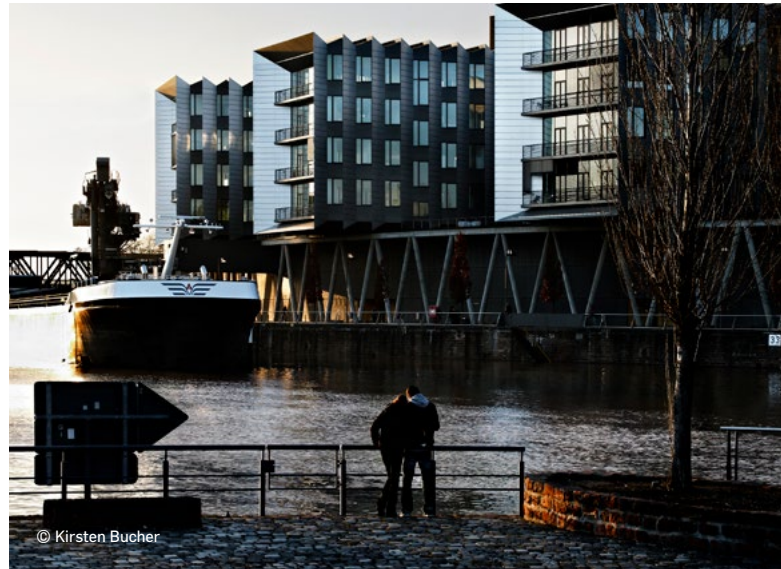

© Kirsten Bucher

The Westhafen Pier is located between the river and a coal-fired power station.



© schneider+schumacher

The research building provides laboratories and offices, exhibition areas, conference rooms, and leisure facilities.

### Research building Shenfang Park

A cooperation zone for innovation in science and technology is being established between Shenzhen and Hong Kong. One of the first buildings to emerge there will be a national center for research and development, for which schneider+schumacher won first prize in an architectural competition. Required was a seminal design that would set the benchmark for all future development. Located next to the river, this building complex rises gradually from the embankment, forming a 120-metre-high office tower. The holistic design approach is representative of a new generation of research buildings.

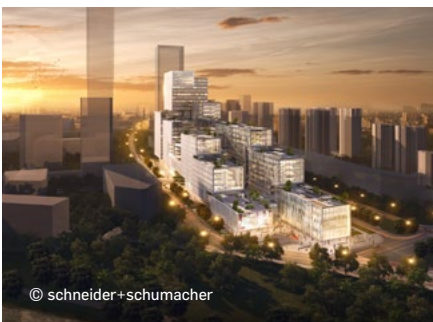

© schneider+schumacher

Roof terraces are a distinctive feature – offering views over the wetlands of Hong Kong on the far riverbank.

location/country: **Shenzhen, China**  
year: **2019-2024**  
gross floor area: **204.494 m²**  
client: **Shenzhen-Hong Kong Science and Technology Innovation Cooperation Zone Development Co., Ltd.**



## **Network for Architecture Exchange NAX**

Askanischer Platz 4  
10963 Berlin  
Germany

+49 (0) 30 . 26 39 44 62  
[info@nax.bak.de](mailto:info@nax.bak.de)

**[www.nax.bak.de](http://www.nax.bak.de)**

Supported by:



Federal Ministry  
for the Environment, Nature Conservation  
and Nuclear Safety



based on a decision of the German Bundestag

Thanks to supporting German Federal Ministry for Environment, Nature Conservation and Nuclear Safety and their Export Initiative for Green Technologies, to our cooperation partners as well as to all the active participants of the SINO-GERMAN CITY LAB, who made it possible to realize this project.